

CONSTRUCTION DURATION INSPECTIONS

SITE PLAN/SKETCH

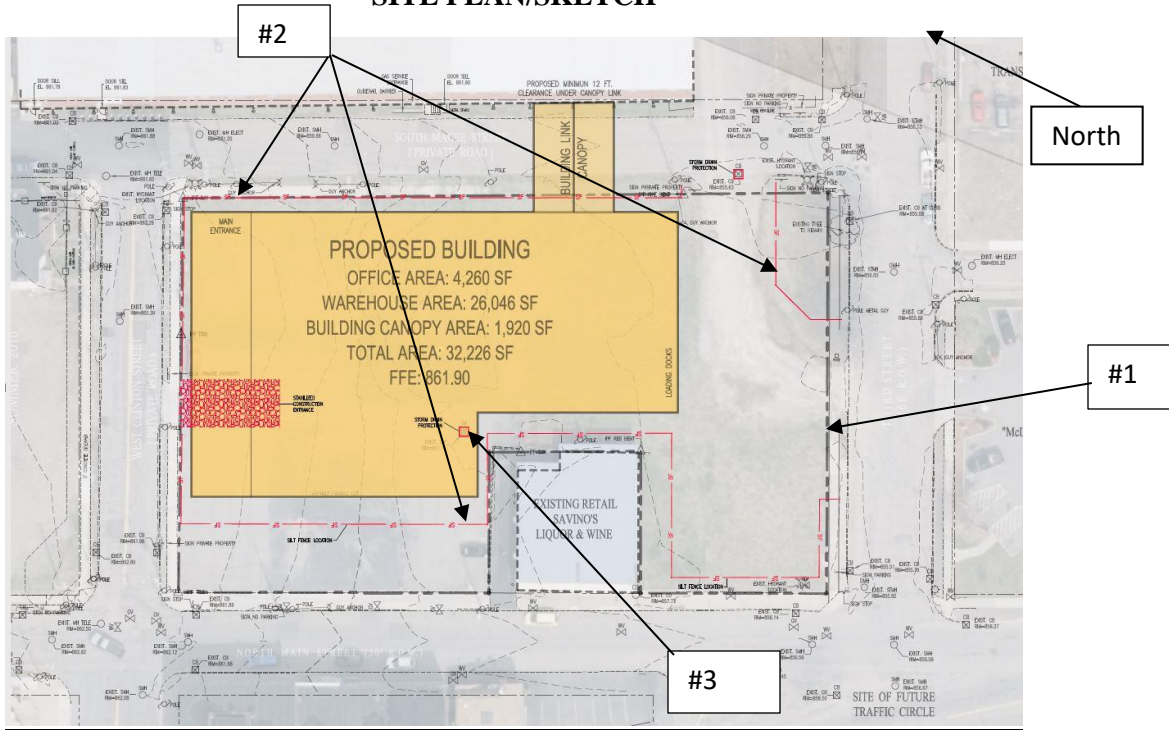

WEATHER: CLOUDY	TEMP: 65°F	TIME: 10:45 AM
SOIL: STABLE	DUST: N/A	SILT FENCE: UNACCEPTABLE
CONCRETE WASHOUT: N/A	STOCKPILES: N/A	DROP INLETS: UNACCEPTABLE
ADJACENT ROADS: ACCEPTABLE	CONSTRUCTION ENTRANCE: UNACCEPTABLE	
ENGINEERED STABILIZATION (NA GREEN): N/A	ROCK OUTLET PROTECTION: N/A	
IS EROSION OCCURRING: NO		
ARE MORE THAN 5 ACRES EXPOSED? NO		

Notes: #1 Construction entrance covered in dirt and incomplete, mud between stone and road.
 #2 Silt fence is in need of repair.
 #3 Stormwater inlet in center of property does not have the proposed sediment control measures and is full of sediment and debris.

Cameron Heggie
 Inspector (Print Name)
 Karl Schwesinger, P.E.
 Qualified Professional (Print Name)

4/26/ 2019
 Date of Inspection
Karl Schwesinger
 Qualified Professional Signature

the above signed acknowledges that, to the best of his/her knowledge, all information provided on the forms is accurate and complete.

CONSTRUCTION DURATION INSPECTIONS

Maintaining Water Quality

Yes No NA

- Is there an increase in turbidity causing a substantial visible contrast to natural conditions?
 Is there residue from oil and floating substances, visible oil film, or globules or grease?
 All disturbance is within the limits of the approved plans.
 Have receiving lake/bay, stream, and/or wetland been impacted by silt from project?

Housekeeping

1. General Site Conditions

Yes No NA

- Is construction site litter and debris appropriately managed?
 Are facilities and equipment necessary for implementation of erosion and sediment control in working order and/or properly maintained?
 Is construction impacting the adjacent property?
-
-

Runoff Control Practices

1. Excavation Dewatering

Yes No NA

- Upstream and downstream berms (sandbags, inflatable dams, etc.) are installed per plan.
 Clean water from upstream pool is being pumped to the downstream pool.
 Sediment laden water from work area is being discharged to a silt-trapping device.
 Constructed upstream berm with one-foot minimum freeboard.
-
-

2. Level Spreader

Yes No NA

- Installed per plan.
 Constructed on undisturbed soil, not on fill, receiving only clear, non sediment laden flow.
 Flow sheets out of level spreader without erosion on downstream edge.
-
-

3. Interceptor Dikes and Swales

Yes No NA

- Installed per plan with minimum side slopes 2H:1V or flatter.
 Stabilized by geotextile fabric, seed, or mulch with no erosion occurring.
 Sediment-laden runoff directed to sediment trapping structure.
-
-
-

CONSTRUCTION DURATION INSPECTIONS

4. Stone Check Dam

Yes No NA

- Is channel stable? (flow is not eroding soil underneath or around the structure).
 Check is in good condition (rocks in place and no permanent pools beneath the structure).
 Has accumulated sediment been removed?
-
-

5. Rock Outlet Protection

Yes No NA

- Installed per plan.
 Installed concurrently with pipe installation.
-
-

Soil Stabilization

1. Topsoil

Yes No NA

- Stockpiles are stabilized with vegetation and/or mulch.
 Sediment control is installed at the toe of slope.
-
-

2. Revegetation / Final Stabilization Disturbed Areas

Yes No NA

- Permanent seedings and mulch have been applied to idle areas.
 4 inches minimum of topsoil has been applied under permanent seedings.
-
-

Sediment Control Practices

1. Stabilized Construction Entrance

Yes No NA

- Stone is clean enough to effectively remove mud from vehicles.
 Installed per standards and specifications?
 Does all traffic use the stabilized entrance to enter and leave the site?
 Is adequate drainage provided to prevent ponding at entrance?
-
-
-

2. Silt Fence

Yes No NA

- Installed on Contour, 10 feet from toe of slope (not across conveyance channels).
 Joints constructed by wrapping the two ends together for continuous support.
 Fabric buried 6 inches minimum.
 Posts are stable, fabric is tight and without rips or frayed areas.

Sediment accumulation is < 90% of design capacity.

See page 1 for locations of deficiencies

CONSTRUCTION DURATION INSPECTIONS

Sediment Control Practices (continued)

3. Storm Drain Inlet Protection (Use for Stone & Block; Filter Fabric; Curb; or, Excavated practices)

Yes No NA

- Compost sock installed around perimeter and staked.
 - Installed concrete blocks lengthwise so open ends face outward, not upward.
 - Placed wire screen between No. 3 crushed stone and concrete blocks.
 - Drainage area is 1 acre or less.
 - Excavated area is 900 cubic feet.
 - Excavated side slopes should be 2:1.
 - 2" x 4" frame is constructed and structurally sound.
 - Posts 3-foot maximum spacing between posts.
 - Fabric is embedded 1 to 1.5 feet below ground and secured to frame/posts with staples at max 8- inch spacing.
 - Posts are stable, fabric is tight and without rips or frayed areas.
- Sediment accumulation 90% of design capacity.
-
-

4. Compost Sediment Trap

Yes No NA

- Installed per plan
 - Is water or sediment bypassing the sediment trap?
- Removed from the site.
-
-

5. Sediment Basin or Infiltration Basin

Yes No NA

- Basin and outlet structure constructed per the approved plan.
 - Basin side slopes are stabilized with seed/mulch.
 - Drainage structure flushed and basin surface restored upon removal of sediment basin facility.
- Sediment accumulation 0% of design capacity.
-
-

Additional Notes:

Note: Not all erosion and sediment control practices are included in this listing. Add additional pages to this list as required by site specific design. Construction inspection checklists for post-development stormwater management practices can be found in Appendix F of the New York Stormwater Management Design Manual.

**HILLIARD CORPORATION EXPANSION
EROSION AND SEDIMENT CONTROL CONSTRUCTION DURATION INSPECTIONS**



1.) Construction entrance at southwestern corner facing north.



2.) Unacceptable stormwater inlet on western side of property facing south (corner of existing Savino's Liquor).



3.) Another view of storm inlet in center of property.



4.) Silt fence off stake. Northeastern corner of property facing south.

**HILLIARD CORPORATION EXPANSION
EROSION AND SEDIMENT CONTROL CONSTRUCTION DURATION INSPECTIONS**



5.) Construction entrance at southwestern corner facing north.



6.) Silt fence off wood stakes. Western side of property facing west.
Just north of Savino's Liquor.

April 26, 2019

SHEET NO. 6